

301

BALL VALVES



FEATURES

- The thread ends conform to ASME B1.20.1 (NPT)
- DIN 2999 & BS 21
- ISO 228/1 & ISO 7/1
- Investment casting
- Blow-out proof stem
- 15% glassfiber fill PTFE reinforce seat
- PTFE seal & packing
- Latch lock handle

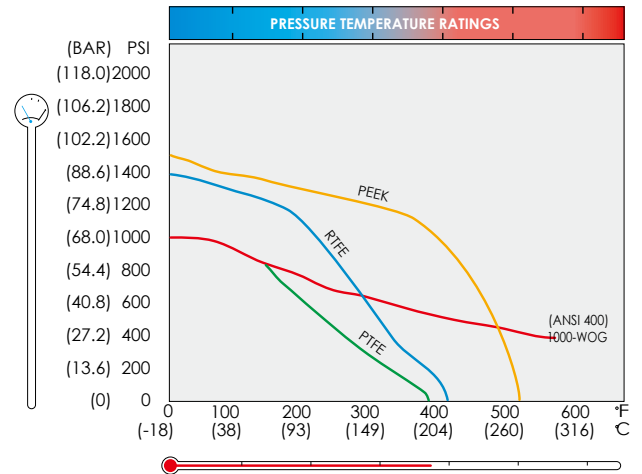
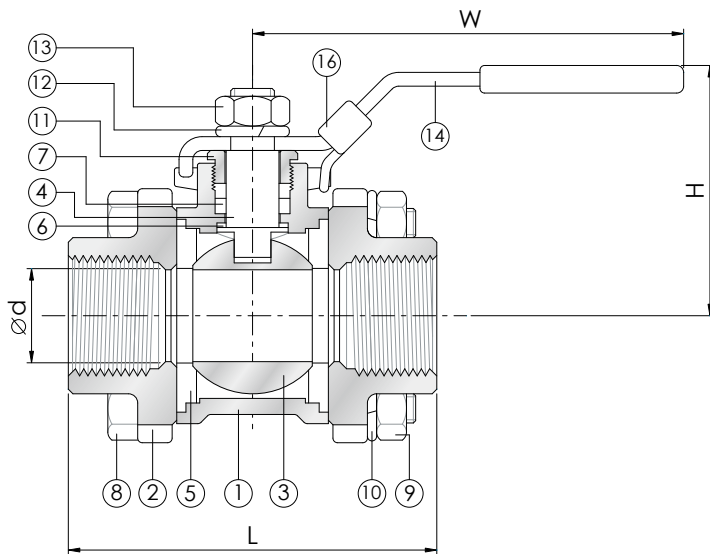
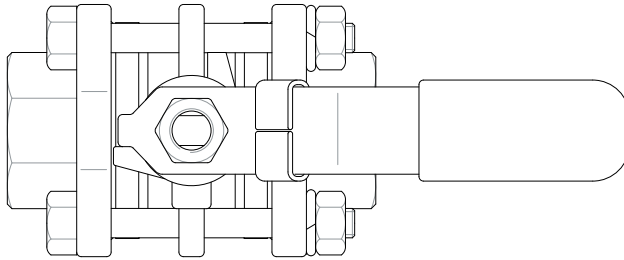

ITEM	PARTS	MATERIAL	ITEM	PARTS	MATERIAL
1	BODY	ASTM A351-CF8M	9	HEX NUT	AISI 304
2	CAP	ASTM A351-CF8M	10	BOLT WASHER	AISI 304
3	BALL	ASTM A351-CF8M	11	GLAND NUT	AISI 304
4	STEM	ASTM A276-316	12	WASHER	AISI 304
5	SEAT	PTFE	13	NUT	AISI 304
6	THRUST WASHER	PTFE	14	HANDLE	AISI 304
7	PACKING	PTFE	16	LOCK DEVICE	AISI 304
8	BOLT	AISI 304			

Thread type					
		NPT	RP	PT	G
NPS	DN	d	L	H	W
1/4"	8	11.6	55	44	101
3/8"	10	13	60	44	101
1/2"	15	16	75	46	101
3/4"	20	20.6	80	53	124
1"	25	25.4	90	57	124
1-1/4"	32	32	110	80	154
1-1/2"	40	38	120	88	154
2"	50	50.8	140	94	154



FEATURES

Design & manufacture conform to BS5351
 Test & Inspect conform to API 598
 Face to Face dimension conform to manufacturer's standard
 NPT ends conform to ANSI B1.20.1
 SW ends conform to ANSI B16.11

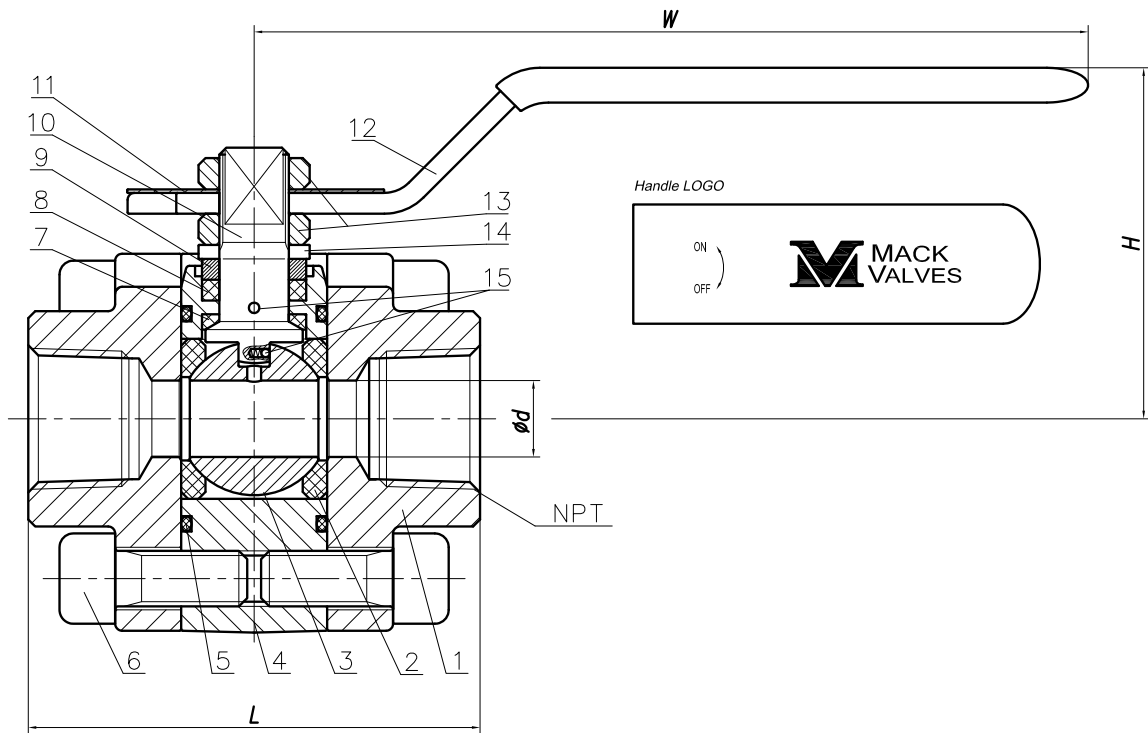

ITEM	PARTS	MATERIAL	ITEM	PARTS	MATERIAL
1	Cap	A105N	9	Gland Nut	A276 410
2	Seat	RTFE	10	Stem	A276 410
3	Ball	A182F6a	11	Name Plate	AL
4	Body	A105N	12	Handle	1045+Zn
5	O-Ring	Viton	13	Nut	1045+Zn
6	Bolt	B7	14	Gasket	65Mn
7	Gasket	PTFE	15	Anti-static Device	316SS
8	Packing	PTFE			

NPS	φd	L	H	W
1/2"	0.559	2.874	2.047	4.724
3/4"	0.807	3.465	2.323	5.709
1"	0.984	4.134	2.559	5.709
1-1/4"	1.244	4.567	3.386	6.693
1-1/2"	1.496	5.039	3.661	6.693
2"	1.929	5.709	4.331	10.236

1000 WOG 3PCS FULL BORE SOCKET WELD BALL VALVES. SW

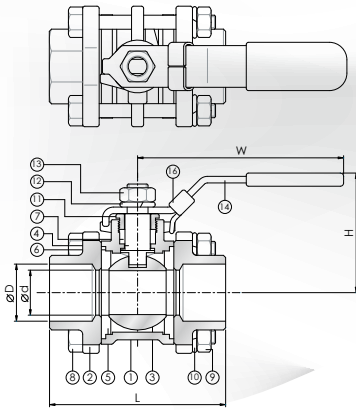

NPS	DN	d	L	H	W
1/4"	0.394	0.709	8.858	1.831	3.150
3/8"	0.492	0.709	8.858	1.831	3.150
1/2"	0.591	0.886	8.858	1.949	3.150
3/4"	0.787	1.102	8.858	2.283	4.134
1"	0.984	1.378	9.646	2.618	4.921
1-1/4"	1.260	1.732	9.646	2.835	4.921
1-1/2"	1.575	1.969	10.236	3.307	6.496
2"	1.969	2.441	10.827	3.661	6.496

311

BALL VALVES

FEATURES

The socket weld ends conform to ANSI B16.11 & DIN 3239 part 2



1000 WOG 3PCS FULL BORE BUTT WELD BALL VALVES. BW

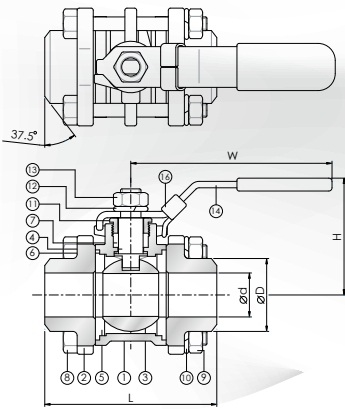

NPS	DN	d	L	H	W
1/4"	0.394	0.709	8.858	1.831	3.150
3/8"	0.492	0.709	8.858	1.831	3.150
1/2"	0.591	0.886	8.858	1.949	3.150
3/4"	0.787	1.102	8.858	2.283	4.134
1"	0.984	1.378	9.646	2.618	4.921
1-1/4"	1.260	1.732	9.646	2.835	4.921
1-1/2"	1.575	1.969	10.236	3.307	6.496
2"	1.969	2.441	10.827	3.661	6.496

321

BALL VALVES

FEATURES

The butt weld ends conform to ANSI B16.25 & DIN 3239 part 1



1000 WOG 3PCS FULL BORE LONG BUTT WELD BALL VALVES. LBW

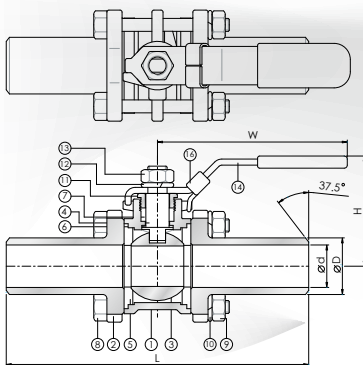

NPS	DN	d	D	L	H	W
1/4"	8	11.6	18	225	44	101
3/8"	10	12.9	18	225	44	101
1/2"	15	16	22.5	225	46	101
3/4"	20	21.6	28	225	53	124
1"	25	27.5	35	245	57	124
1-1/4"	32	36	44	255	80	154
1-1/2"	40	42.2	50	260	88	154
2"	50	53.5	62.5	275	94	154

331

BALL VALVES

FEATURES

The butt weld ends conform to ANSI B16.25 & DIN 3239 part 1



800 WOG UNIBODY REDUCE BORE SCREWED BALL VALES.

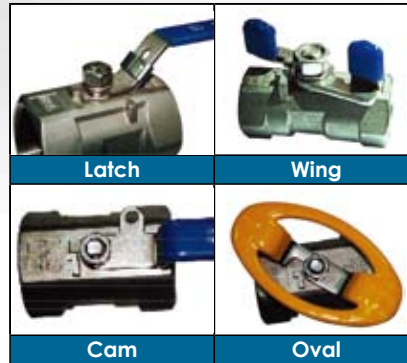
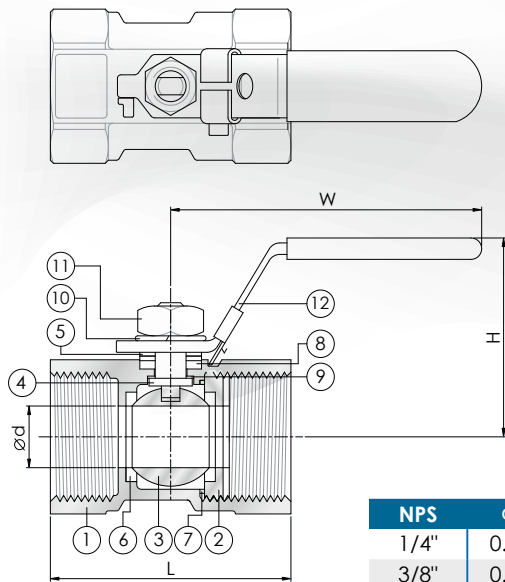

NPS	ϕd	L	H	W	Weight
1/4"	0.197	1.535	1.024	2.480	0.154
3/8"	0.276	1.732	1.063	2.953	0.220
1/2"	0.354	2.205	1.417	3.346	0.375
3/4"	0.492	2.441	1.516	3.346	0.551
1"	0.591	2.756	1.752	4.528	0.920
1-1/4"	0.787	3.031	1.929	4.528	1.389
1-1/2"	0.984	3.346	2.264	5.315	1.841
2"	1.260	3.937	2.500	5.315	2.945

K16

BALL VALVES



FEATURES

The thread ends conform to
ASME B1.20.1 (NPT)
DIN 2999 & BS 21
ISO 228/1 & ISO 7/1
Investment casting
Blow-out proof stem
15% glassfiber fill PTFE
reinforce seat
PTFE seal & packing

缺檔案C21-000D3-B 線圖

1000 WOG UNIBODY REDUCE BORE SCREWED BALL VALES.

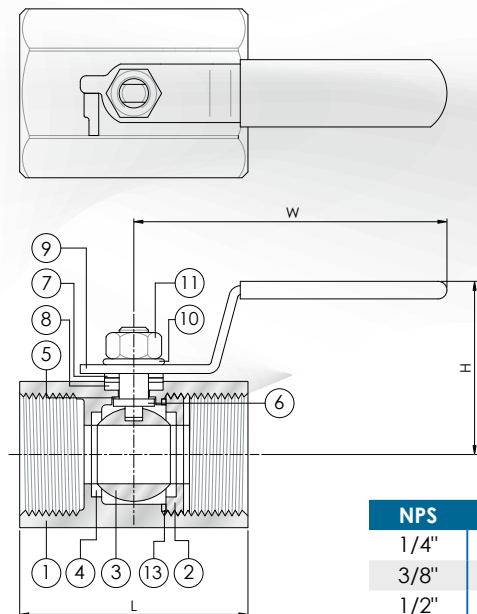

ITEM	PARTS	MATERIAL
1	BODY	ASTM A351-CF8M
2	RETAINER	ASTM A351-CF8M
3	BALL	ASTM A351-CF8M
4	BALL STEM	RTFE/PTFE
5	THRUST WASHER	PTFE
6	STEM	AISI 316
7	GLAND	AISI 304
8	PACKING	PTFE
9	HANDEL	AISI 304
10	HANDEL WASHER	AISI 304
11	HANDEL NUT	AISI 304
12	BODY SEAL	PTFE

NPS	DN	d	L	H	W
1/4"	8	5	39	35	67
3/8"	10	7	44	37	70
1/2"	15	9	56.5	43.5	90
3/4"	20	12.5	58	47	90
1"	25	16	71	50	103
1-1/4"	32	20	78	57	103
1-1/2"	40	24.6	83	69	127
2"	50	32	100	74.5	127

K17

BALL VALVES



FEATURES

The thread ends conform to
ASME B1.20.1 (NPT)
DIN 2999 & BS 21
ISO 228/1 & ISO 7/1
Investment casting
Blow-out proof stem
15% glassfiber fill PTFE
reinforce seat
PTFE seal & packing
Cam lock handle(option)
Polished-K17P(option)

F315

BALL VALVES



FEATURES

The thread ends conform to
 ASME B1.20.1 (NPT)
 DIN 2999 & BS 21
 ISO 228/1 & ISO 7/1
 Investment casting
 Blow-out proof stem
 15% glassfiber fill PTFE
 reinforce seat
 PTFE seal & packing
 Latch lock handle

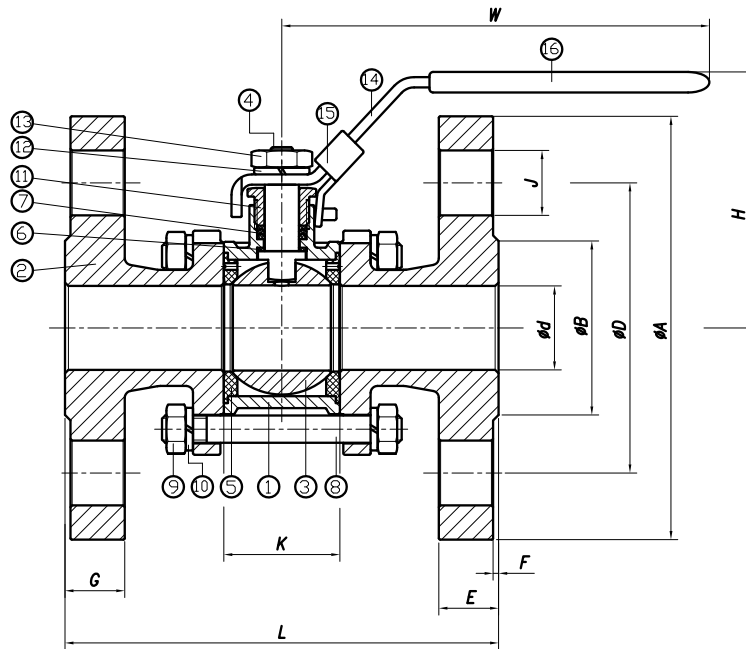

NPS	ΦB	ΦC	Φd	ΦD	E	F	L	H	W
1/2"	1.378	2.559	0.591	3.740	0.559	0.063	0.394	2.264	3.150
3/4"	1.693	2.953	0.787	4.606	0.618	0.063	4.606	2.717	4.134
1"	2.008	3.346	0.984	4.882	0.689	0.063	5.000	2.874	4.921
1-1/4"	2.520	3.937	1.260	5.236	0.748	0.063	5.512	3.051	4.921
1-1/2"	2.874	4.331	1.575	6.102	0.807	0.063	4.496	3.524	6.496
2"	3.622	4.921	1.969	6.496	0.886	0.063	7.008	3.720	4.496

Item	Part Name	Material
1	Body	CF8M
2	Cap	CF8M
3	Ball	CF8M
4	Stem	316
5	Ball Seat	RTFE
6	Thrust Washer	PTFE
7	Packing	PTFE
8	Bolt	304
9	Nut	304
10	Spring Washer	304
11	Gland Nut	304
12	Spring Washer	304
13	Nut	304
14	Handle	304
15	Lock Device	304
16	Handle Sleeve	VINYL

200 WOG SCREWED SWING CHECK VALVES.

Item	Part Name	Material
1	BODY	ASTM A351-CF8M
2	CAP	ASTM A351-CF8M
3	HINGE	SUS 316
4	DISC	ASTM A351-CF8M
5	GASKET	PTFE
6	PLUG	SUS 316
7	PLUG PACKING	PTFE

NPS	DN	L	H	D
3/8"	10	65	45	13
1/2"	15	65	45	15
3/4"	20	80	56	20
1"	25	90	62	25
1-1/4"	32	105	67	32
1-1/2"	40	120	73	40
2"	50	140	82	50
2-1/2"	65	180	93	65
3"	80	200	104	80

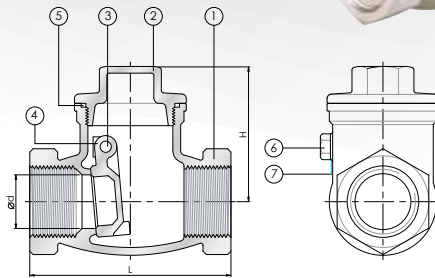

J50

CHECK VALVES

FEATURES

The thread ends conform to
ASME B1.20.1 (NPT)
DIN 2999 & BS21
ISO 228/1 & ISO 7/1
Investment casting
200 W.O.G
Max working temperature
445°F

200 WOG SCREWED GLOBE VALVES.

Item	Part Name	Material
1	BODY	ASTM A351-CF8M
2	DISC	AISI 316
3	STEM	AISI 316
4	BONNET	ASTM A351-CF8M
5	GASKET	PTFE
6	WASHER	AISI 304
7	STEM PACKING	PTFE
8	GLAND	AISI 304
9	GLAND NUT	AISI 316
10	HANDLE WHEEL	MICO STEEL
11	NAME PLATE	ALUMINUM
12	WHEEL WASHER	AISI 304
13	WHEEL NUT	AISI 304

NPS	DN	d	L	W	H-open
1/4"	8	11	52	89	57
3/8"	10	11	52	89	57
1/2"	15	12	52	89	57
3/4"	20	15	60	97	70
1"	25	20	72	107	80
1-1/4"	32	25	80	125	90
1-1/2"	40	32	91	140	90
2"	50	38	101	165	100

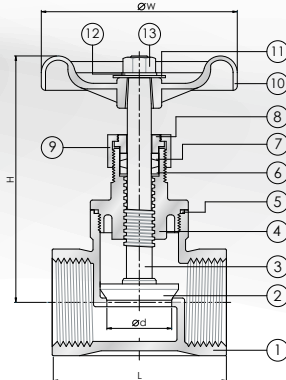

J60

GLOBE VALVES

FEATURES

The thread ends conform to
ASME B1.20.1 (NPT)
DIN 2999 & BS 21
ISO 228/1 & ISO 7/1
Investment casting
Rising stem
200 W.O.G.
Max working temperature
445°F

200 WOG SCREWED GATE VALVES.

Item	Part Name	Material
1	BODY	ASTM A351-CF8M
2	DISC	ASTM A351-CF8M
3	STEM	AISI 316
4	BONNET	ASTM A351-CF8M
5	GASKET RING	PTFE
6	STEM HOLDER	AISI 316
7	STEM PACKING	PTFE
8	GLAND	AISI 304
9	GLAND NUT	AISI 304
10	HANDEL WHEEL	MICO STEEL
11	NAME PLATE	ALUMINUM
12	WHEEL WASHER	AISI 304
13	WHEEL NUT	AISI 304

NPS	DN	d	L	W
15	15	95	55	70
20	20	102	60	70
25	25	115	65	80
32	32	127	75	80
40	38	150	85	90
50	50	170	95	100

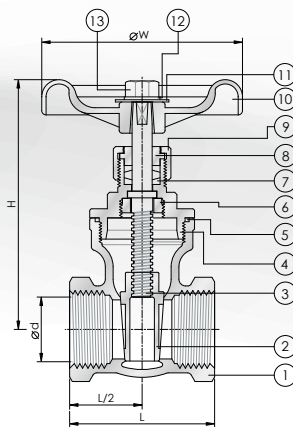

J70

GATE VALVES

FEATURES

The thread ends conform to
ASME B1.20.1 (NPT)
DIN 2999 & BS 21
ISO 228/1 & ISO 7/1
200 W.O.G.
Max working temperature
445°F
Non-rising stem

800 WOG SCREWED PISTON CHECK VALVES.

Item	Part Name	Material
1	BODY	ASTM A351-CF8M
2	CAP	ASTM A351-CF8M
3	SPRING	AISI 316
4	PISTON	ASTM A276-316
5	SEAT	PTFE
6	WASHER	AISI 304
7	NUT	AISI 304
8	GASKET	PTFE

NPS	DN	L	H	W	d
1/4"	8	65	46	19	11
3/8"	10	65	46	19	13
1/2"	15	65	46	19	15
3/4"	20	80	58	23	20
1"	25	90	69	27	25
1-1/4"	32	105	75	32	32
1-1/2"	40	120	85	41	38
2"	50	140	98	50	50

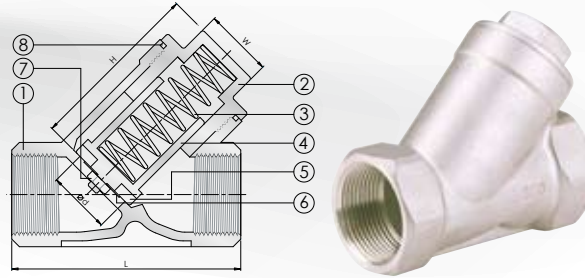

J51

CHECK VALVES

FEATURES

The thread ends conform to ASME B1.20.1(NPT) DIN 2999 & BS 21 ISO 228/1 & ISO 7/1 Investment casting Max working temperature 445°F PN 40 The end to end conforms to DIN 3202 part 4 series M8

800 WOG SCREWED SHUT OFF VALVES.

Item	Part Name	Material
1	BODY	ASTM A351-CF8M
2	NUT	AISI 304
3	WASHER	AISI 304
4	SEAT	PTFE
5	DISC	AISI 316
6	STEM	AISI 316
7	BONNET	ASTM A351-CF8M
8	GASKET	PTFE
9	STEM PACKING	PTFE
10	GLAND RING	AISI 304
11	GLAND NUT	AISI 304
12	HANDLE WHEEL	MICO STEEL
13	NAME PLATE	ALUMINUM
14	WASHER	AISI 304
15	NUT	AISI 304

DN	L	H-open	d
8	65	107	11
10	65	107	13
15	65	107	15
20	80	122	20
25	90	142	25
32	105	155	32
40	120	175	38
50	140	195	50

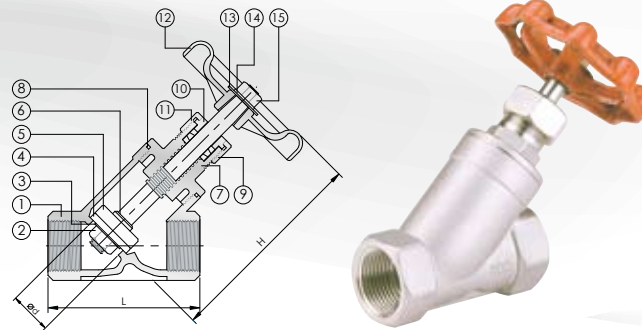

J66

SHUT OFF VALVES

FEATURES

The thread ends conform to ASME B1.20.1(NPT) DIN 2999 & BS 21 ISO 228/1 & ISO 7/1 Investment casting Rising stem 800 W.O.G. Max working temperature 445°F

800 WOG SCREWED Y STRAINER.

Item	Part Name	Material
1	BODY	ASTM A351-CF8M
2	SCREEN	AISI 316
3	GASKET	PTFE
4	BONNET	ASTM A351-CF8M
5	PLUG GASKET	PTFE
6	PLUG	ASTM A351-CF8M

NPS	DN	d	B	H	L
1/4"	8	11	23	46	65
3/8"	10	13	23	46	65
1/2"	15	15	26	46	65
3/4"	20	20	32	55	80
1"	25	25	41	70	90
1-1/4"	32	32	49	73	105
1-1/2"	40	38	56	81	120
2"	50	50	69	94	140
2-1/2"	65	65	87	120	170
3"	80	80	102	140	200

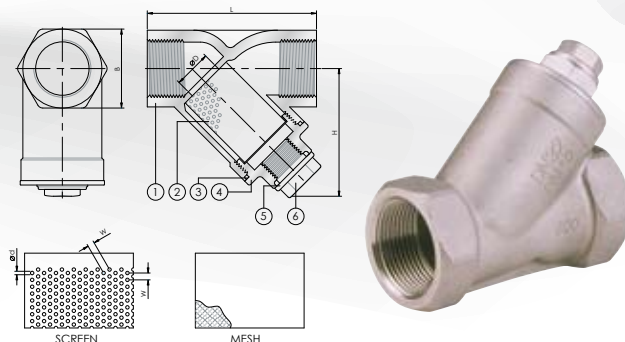

J90

Y STRAINER

FEATURES

The thread ends conform to ASME B1.20.1(NPT) DIN 2999 & BS 21 ISO 228/1 & ISO 7/1 Investment casting Max working temperature 445°F 600 psi W.O.G.

6000 WOG F/F SCREWED NEEDLE VALVES.

Item	Part Name	Material
1	BODY	ASTM A276-316
2	BONNET	ASTM A351-CF8M
3	STEM	AISI 316
4	GLAND NUT	AISI 304
5	GLAND	AISI 304
6	PACKING	PTFE
7	HANDLE	AISI 410
8	SET SCREW	AISI 304

NPS	DN	H-open	L
1/4"	8	75	58
3/8"	10	75	58
1/2"	15	87	65
3/4"	20	90	70
1"	25	103	80

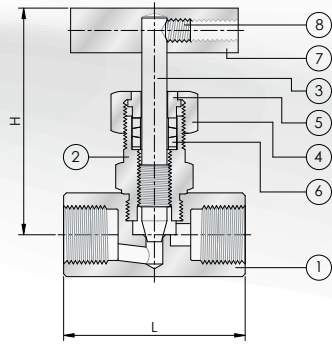

J80

NEEDLE VALVES

FEATURES

The thread ends conform to
ASME B1.20.1 (NPT)
DIN 2999 & ISO 7/1
6000 psi
PTFE packing

6000 WOG M/F SCREWED NEEDLE VALVES.

Item	Part Name	Material
1	BODY	ASTM A276-316
2	BONNET	ASTM A351-CF8M
3	STEM	AISI 316
4	GLAND NUT	AISI 304
5	GLAND	AISI 304
6	PACKING	PTFE
7	HANDLE	AISI 410
8	SET SCREW	AISI 304

NPS	DN	H-open	L
1/4"	8	75	58
3/8"	10	75	58
1/2"	15	87	65
3/4"	20	90	70
1"	25	103	80

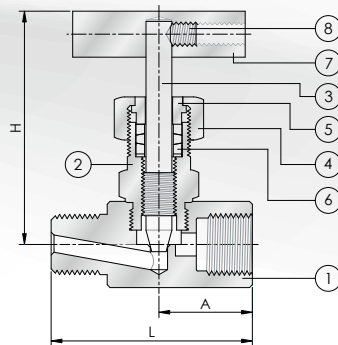

J81

NEEDLE VALVES

FEATURES

The thread ends conform to
ASME B1.20.1 (NPT)
DIN 2999 & ISO 7/1
6000 psi
PTFE packing

6000 WOG SCREWED ANGLE NEEDLE VALVES.

Item	Part Name	Material
1	BODY	ASTM A276-316
2	BONNET	ASTM A351-CF8M
3	STEM	AISI 316
4	GLAND NUT	AISI 304
5	GLAND	AISI 304
6	PACKING	PTFE
7	HANDLE	AISI 410
8	SET SCREW	AISI 304

NPS	DN	H-open	L
1/4"	8	75	29
3/8"	10	75	29
1/2"	15	87	34
3/4"	20	90	38
1"	25	103	45

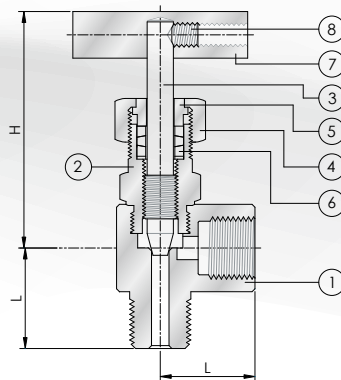

J82

NEEDLE VALVES

FEATURES

The thread ends conform to
ASME B1.20.1 (NPT)
DIN 2999 & ISO 7/1
6000 psi
PTFE packing